



LINDAU NOBEL LAUREATE MEETINGS

7th Lindau Meeting on Economic Sciences

Programme

23 – 27 August 2022

Sessions

Scientific sessions,
social functions,
partner events,
networking breaks

Speakers

Laureates, young
economists, invited
experts,
moderators

Access

Guidance to all
online viewing
and participation
options

Background

Everything else
there is to know
for a successful
meeting

ON-SITE

Access to sessions may depend on participant type and pre-registration.

Please see the **on-site programme (p. 8)** and your **personal agenda** for details.

Where Q&A is offered, you may use microphones provided or ask your questions online at qa.lindau-nobel.org

ONLINE

Online participation and interaction are available for registered participants.

Please see the **online programme (p. 10)** for details.

You can follow the programme and ask questions at live.lindau-nobel.org

PUBLIC

Selected sessions are available for the public.

Please see the **online programme (p. 10)** for details.

The public programme is available at public.lindau-nobel.org

TABLE OF CONTENTS **3**

Scientific Programme	8
About the Meetings	42
Online Offers	46
Supporters	48
Maps	54
Good to Know	62

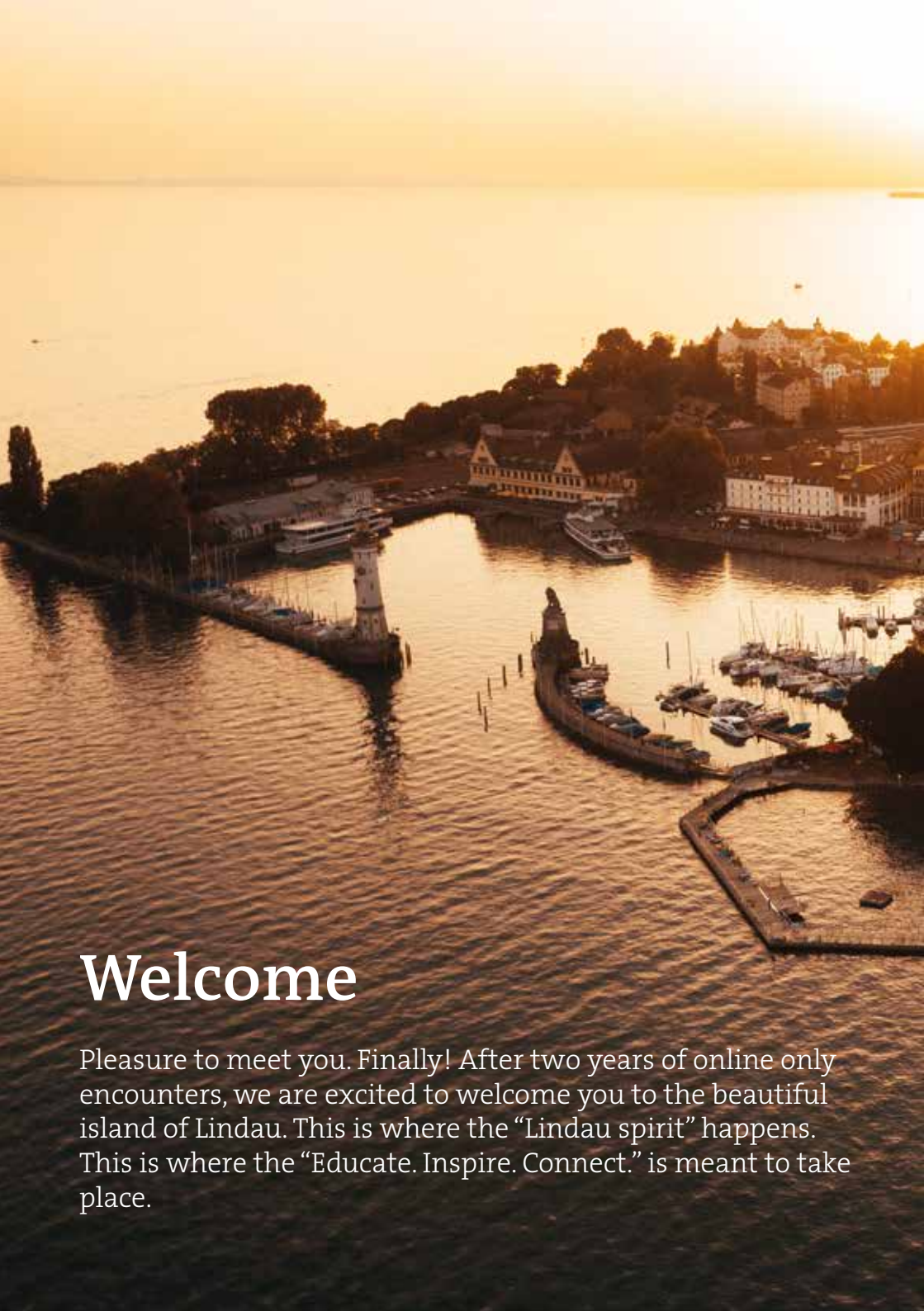

Welcome

Pleasure to meet you. Finally! After two years of online only encounters, we are excited to welcome you to the beautiful island of Lindau. This is where the “Lindau spirit” happens. This is where the “Educate. Inspire. Connect.” is meant to take place.



Together, let us celebrate the 7th Lindau Meeting on Economic Sciences. Bridging borders, nationalities, ethnicities, languages, religions in times where it is needed, possibly more than ever before. Let us use this gathering in the sense of Alfred Nobel: “For the benefit of humankind”.

6 PARTICIPATING LAUREATES

Richard H.
Thaler



Lars Peter
Hansen



Robert C.
Merton



Joseph E.
Stiglitz



Oliver
Hart



Eric S.
Maskin



Sir
Christopher A.
Pissarides

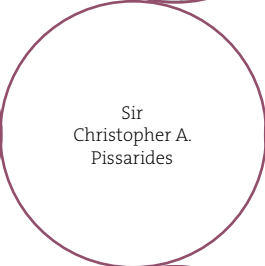

Christopher A.
Sims



Bengt R.
Holmström



PARTICIPATING LAUREATES 7

Robert B.
Wilson



James J.
Heckman



Finn E.
Kydland

Daniel L.
McFadden



Joshua D.
Angrist

Robert J.
Aumann



Edmund S.
Phelps



Vernon L.
Smith



Roger B.
Myerson



Paul R.
Milgrom

8 PROGRAMME OVERVIEW ON-SITE

<u>Time (Zones)</u>	<u>Tuesday, 23 August</u>	<u>Wednesday, 24 August</u>
07 B13 / T14 / C15 D10 ³⁰ / N01 / S22 ²		<p><u>Partner Event</u> Beisheim Stiftung</p> <p><u>Break</u> Morning Workout</p>
08 B14 / T15 / C16 D11 ³⁰ / N02 / S23 ¹		
09 B15 / T16 / C17 D12 ³⁰ / N03 / S24 ¹		<p><u>Lecture</u> Angrist</p> <p><u>Lecture</u> Heckman</p>
10 B16 / T17 / C18 D13 ³⁰ / N04 / S01		
11 B17 / T18 / C19 D14 ³⁰ / N05 / S02		<p><u>Next Gen Economics</u> <u>Research by young economists:</u></p> <ul style="list-style-type: none"> • Microeconomic Theory and Game Theory • Microeconometrics: Methodology and Applications
12 B18 / T19 / C20 D15 ³⁰ / N06 / S03		
13 B19 / T20 / C21 D16 ³⁰ / N07 / S04		
14 B20 / T21 / C22 D17 ³⁰ / N08 / S05	<p><u>Opening Ceremony</u></p>	<p><u>Break</u> Lunch Break Laureate Lunches</p>
15 B21 / T22 / C23 D18 ³⁰ / N09 / S06	<p><u>Lecture</u> Milgrom</p> <p><u>Lecture</u> Wilson</p>	<p><u>Lecture</u> Myerson</p> <p><u>Lecture</u> Aumann</p> <p><u>Lecture</u> Hansen</p>
16 B22 / T23 / C24 D19 ³⁰ / N10 / S07	<p><u>Reception</u></p>	
17 B23 / T24 / C01 ¹ D20 ³⁰ / N11 / S08		<p><u>Panel Discussion</u> Applied Micro Revolution Angrist, Lassen, McFadden, Pollmann</p>
18 B24 / T01 ¹ / C02 ¹ D21 ³⁰ / N12 / S09	<p><u>Panel Discussion</u> Auctions Acquatella, Milgrom, Myerson, Wilson</p>	<p><u>Reception</u></p>
19 B01 ¹ / T02 ¹ / C03 ¹ D22 ³⁰ / N13 / S10	<p><u>Social Programme</u> Dinner for young economists</p>	<p><u>Social Programme</u> Get-Together</p>
20 B02 ¹ / T03 ¹ / C04 ¹ D23 ³⁰ / N14 / S11		
21 B03 ¹ / T04 ¹ / C05 ¹ D00 ³⁰ / N15 / S12		

* Note: All programme sessions are subject to change.

ON-SITE PROGRAMME OVERVIEW 9

Thursday, 25 August

Friday, 26 August

Saturday, 27 August

	<p><u>Partner Event</u> PwC Pricewater- houseCoopers</p>	<p><u>Break</u> Morning Workout</p>	
			<p><u>Social Event</u> Boat Trip to Mainau Island</p>
<p><u>Lecture</u> Hart</p> <p><u>Lecture</u> Stiglitz</p> <p><u>Lecture</u> Maskin</p>	<p><u>Lecture</u> Phelps</p> <p><u>Lecture</u> Kydland</p> <p><u>Lecture</u> Pissarides</p>		
<p><u>Next Gen Economics</u> <i>Research by young economists:</i></p> <ul style="list-style-type: none"> • Macroeconomics: Macro, Labor/ Search, International, Finance • Applied Microeconomics: Environment, Health, Labor 	<p><u>Lecture</u> Sims</p> <p><u>Lecture</u> Merton</p>	<p><u>Panel Discussion</u> Economics and Politics of War and Sanctions Hart, Maskin, Meuchelböck, Pissarides</p>	
	<p><u>Break</u> Lunch Break Laureate Lunches</p>		<p><u>Closing Ceremony</u></p> <p><u>Social Event</u> Science Picnic</p>
<p><u>Break</u> Lunch Break Laureate Lunches</p>	<p><u>Next Gen Economics</u> <i>Research by young economists:</i></p> <ul style="list-style-type: none"> • Applied Microeconomics: Environment, Development, Labor • Applied Microeconomics: Political Economics, Gender, IO 		
<p><u>Lecture</u> Thaler</p> <p><u>Lecture</u> Smith</p> <p><u>Lecture</u> McFadden</p>			
	<p><u>Science Walks</u></p>		<p><u>Social Event</u> Boat Trip to Lindau Island</p>
<p><u>Panel Discussion</u> Social Change and Social Media Andreottola, Hartinger, Holmström, Stiglitz, Thaler</p>			
<p><u>Social Programme</u> Dinner for young economists</p>	<p><u>Social Programme</u> Bavarian Evening hosted by the Free State of Bavaria</p>		

Time Zones

The reference times on the left side are stated as Central European Summer Time (CEST).

Additional times zones are provided as smaller print.

B = Beijing (CST)

T = Tokyo (JST)

C = Canberra (AEST)

D = Delhi (IST)

N = New York (EDT/DST)

S = San Francisco (PDT/DST)

⁻¹ = day before

⁺¹ = day after

³⁰ + plus 30 minutes

10 PROGRAMME OVERVIEW ONLINE

<u>Time (Zones)</u>	<u>Tuesday, 23 August</u>	<u>Wednesday, 24 August</u>
07	B13 / T14 / C15 D10 ³⁰ / N01 / S22 ¹	
08	B14 / T15 / C16 D11 ³⁰ / N02 / S23 ¹	
09	B15 / T16 / C17 D12 ³⁰ / N03 / S24 ¹	<u>Lecture</u> Angrist
10	B16 / T17 / C18 D13 ³⁰ / N04 / S01	<u>Lecture</u> Heckman
11	B17 / T18 / C19 D14 ³⁰ / N05 / S02	<u>Next Gen Economics</u> <i>Research by young economists:</i> • Microeconomic Theory and Game Theory • Microeconometrics: Methodology and Applications
12	B18 / T19 / C20 D15 ³⁰ / N06 / S03	
13	B19 / T20 / C21 D16 ³⁰ / N07 / S04	
14	B20 / T21 / C22 D17 ³⁰ / N08 / S05	<u>Opening Ceremony</u>
15	B21 / T22 / C23 D18 ³⁰ / N09 / S06	<u>Lecture</u> Milgrom
16	B22 / T23 / C24 D19 ³⁰ / N10 / S07	<u>Lecture</u> Myerson
17	B23 / T24 / C01 ¹ D20 ³⁰ / N11 / S08	<u>Lecture</u> Aumann
18	B24 / T01 ¹ / C02 ¹ D21 ³⁰ / N12 / S09	<u>Lecture</u> Hansen
19	B01 ¹ / T02 ¹ / C03 ¹ D22 ³⁰ / N13 / S10	<u>Panel Discussion</u> Applied Micro Revolution Angrist, Lassen, McFadden, Pollmann
20	B02 ¹ / T03 ¹ / C04 ¹ D23 ³⁰ / N14 / S11	
21	B03 ¹ / T04 ¹ / C05 ¹ D00 ³⁰ / N15 / S12	

* Note: All programme sessions are subject to change.

ONLINE PROGRAMME OVERVIEW 11

Thursday, 25 August

Friday, 26 August

Saturday, 27 August

<u>Lecture</u> Hart	<u>Lecture</u> Phelps
<u>Lecture</u> Stiglitz	<u>Lecture</u> Kydland
<u>Lecture</u> Maskin	<u>Lecture</u> Pissarides

Next Gen Economics
Research by young economists:

- Macroeconomics: Macro, Labor/ Search, International, Finance
- Applied Microeconomics: Environment, Health, Labor

<u>Lecture</u> Sims
<u>Lecture</u> Merton

Panel Discussion
Economics and Politics of War and Sanctions
Hart, Maskin, Meuchelböck, Pissarides

Closing Ceremony

<u>Lecture</u> Thaler
<u>Lecture</u> Smith
<u>Lecture</u> McFadden

Next Gen Economics
Research by young economists:

- Applied Microeconomics: Environment, Development, Labor
- Applied Microeconomics: Political Economics, Gender, IO

Panel Discussion
Social Change and Social Media
Andreottola, Hartinger, Holmström, Stiglitz, Thaler

Social Programme
Bavarian Evening Online with Brian Malow

Sessions colored in orange are publicly available at public.lindau-nobel.org

Time Zones
The reference times on the left side are stated as Central European Summer Time (CEST).
Additional times zones are provided as smaller print.
B = Beijing (CST)
T = Tokyo (JST)
C = Canberra (AEST)
D = Delhi (IST)
N = New York (EDT/DST)
S = San Francisco (PDT/DST)
⁻¹ = day before
⁺¹ = day after
³⁰ + plus 30 minutes



Let's get started
OPENING CEREMONY
7th Lindau Meeting
on Economic Sciences
#LINOecon



LINO 22



14 MEETING PROGRAMME TUESDAY AUGUST 23

Opening Ceremony

14.00

Inselhalle

Opening of the 7th Lindau Meeting on Economic Sciences

Welcome

Countess Bettina Bernadotte, President of the Council

Greetings from Stockholm

Sketches of Science

Volker Steger, Adam Smith & Countess Bettina Bernadotte

Programme Preview

Torsten Persson, Klaus Schmidt, Antoinette Schoar

Scientific Chairpersons of the 7th Lindau Meeting on Economic Sciences

Master of Ceremony: Adam Smith

Nobel Prize Outreach, Sweden

Lecture

15.00

Inselhalle

Markets for Water in California

Paul R. Milgrom

Stanford University, United States of America

Lecture

15.30

Inselhalle

Auction Implementation of a Rational Expectations Equilibrium

Robert B. Wilson

Stanford University, United States of America

Social Event

16.00

Inselhalle



Reception

Panel Discussion

17.30
Inselhalle

Auctions

Angie Acquatella
Harvard University, United States of America

Paul R. Milgrom
Stanford University, United States of America

Roger B. Myerson
The University of Chicago, United States of America

Robert B. Wilson
Stanford University, United States of America

Moderator: Klaus M. Schmidt
Ludwig-Maximilians-Universität, Germany

Social Event

19.00 – 21.30
Inselhalle



Dinner

Access: young economists

Online Event

19.00 – 21.30

Online Meet-up

See live.lindau-nobel.org for details.





Tonight

GET-TOGETHER

Wednesday, August 24, 18.30 CEST

Morning Workout **Activate**

07.00

Oscar-Groll-Anlage

Partner Event

07.00

Hotel Bayer. Hof



Responsibility of Science and Business in our Current Societies

hosted by Beisheim Stiftung, Germany

Reimar Belschner

WHU-Otto Beisheim School of Management, Germany

Oliver Hart

Harvard University, United States of America

Mei Wang

WHU-Otto Beisheim School of Management, Germany

Moderator: Nadine Kammerlander

WHU-Otto Beisheim School of Management, Germany

Lecture

09.00

Inselhalle

Designing Financial Aid for Research

Joshua D. Angrist

MIT Massachusetts Institute of Technology, United States of America

Lecture

09.30

Inselhalle

How the Welfare State Affects Inequality and Social Mobility: A Comparison of the U.S. and Denmark

James J. Heckman

The University of Chicago, United States of America

10.00

Break

**Next Gen
Economics**

11.00

Inselhalle

with Laureates

Robert J. Aumann

Paul R. Milgrom

Roger B. Myerson

Microeconomic Theory and Game Theory

Zero-Knowledge Mechanisms

Yannai Gonczarowski

Harvard University, United States of America

Guidance via Narratives

Adam Brzezinski

University of Oxford, United Kingdom

Designing Labor Market Recommender Systems:

The Importance of Job Seeker Preferences and Competition

Christophe Gaillac

University of Oxford, Nuffield College, United Kingdom

Portfolio Choice and Common Ownership in General Equilibrium

Marco Loseto

University of Chicago, United States of America

War and Peace

Henk Schouten

University of Western Ontario, Canada

Optimal Design of Pharmaceutical Contracts

for Static and Dynamic Efficiency

Angie Acquatella

Harvard University, United States of America

The Acquisition Option and Startup Innovations

Katarina Warg

Stockholm School of Economics, Sweden and Copenhagen Business School, Denmark

Endogenous Information Acquisition in Cheap-Talk Games

Sophie Kreutzkamp

University of Bonn, Germany

Investigating New Policies for Financial Stability

That Do Not Create Inequality

Jagoda Kaszowska-Mojsa

University of Oxford, United Kingdom

Simplistic Rhetoric and Poe's Law

Giovanni Andreottola

Vienna University of Economics and Business (WU), Austria

Moderator: Klaus M. Schmidt

Ludwig-Maximilians-Universität, Germany

**Next Gen
Economics**

11.00

Hotel Bayer. Hof

with Laureates

Joshua D. Angrist

James J. Heckman

Microeconometrics: Methodology and Applications

Digitalization and Resilience to Disaggregate Shocks

Andreas Tryphonides

University of Cyprus, Cyprus

Causal Inference for Spatial Treatments

Michael Pollmann

Duke University, United States of America

Spillover Effects of Immigration Policies on Children's Human Capital

Esther Arenas Arroyo

Vienna University of Economics and Business (WU), Austria

Variable Selection in Linear Regressions
with Many Highly Correlated Covariates

Mahrad Sharifvaghefi

University of Pittsburgh, United States of America

Overworking Public Defenders

Aviv Caspi

Stanford University, United States of America

War Time Military Service Increases Religiosity:

Causal Big-Data Evidence From the Vietnam War Lottery

Wladislaw Mill

University of Mannheim, Germany

Binary Response Dynamic Panel Data Models
with Switching State Dependence

Eleni Aristodemou

University of Cyprus, Cyprus

Time Series Dynamics Based on Network Structure

Marko Mlikota

University of Pennsylvania, United States of America

The Macroeconomic Effect of Fiscal Policy in South Africa:

A Narrative Analysis

Tumisang Loate

University of Pretoria, South Africa

“Fabric of Federalism”: The Impact of Litigant Rights’ Reform
and Women Empowerment in Nigeria

Oluwabunmi Adejumo

Obafemi Awolowo University, Nigeria

Moderator: Antoinette Schoar

MIT Massachusetts Institute of Technology, United States of America

13.00

Inselhalle



Lunch Break

13.15

Various Locations



Laureate Lunches

Access: Laureates, young economists with online pre-registration only.

Please see your personal agenda for details.

Lecture

15.00

Inselhalle

Game Theory and the First World War

Roger B. Myerson

The University of Chicago, United States of America

Lecture

15.30

Inselhalle

Behavioral Economics and Mainstream Economics

Robert J. Aumann

The Hebrew University of Jerusalem, United States of America

Lecture Online

16.00

Inselhalle

Confronting Uncertainty in Climate Change and its Ramifications

Lars Peter Hansen

The University of Chicago, United States of America

16.30

Break

Panel Discussion

17.00

Inselhalle

Applied Micro Revolution

Joshua D. Angrist

MIT Massachusetts Institute of Technology, United States of America

Anne Sophie Lassen

Copenhagen Business School, Denmark

Daniel L. McFadden

University of California, Berkeley, United States of America

Michael Pollmann

Duke University, United States of America

Moderator: Antoinette Schoar

MIT Massachusetts Institute of Technology, United States of America

Social Event

18.30 – 22.00

Inselhalle



Get-Together

Welcome

Countess Bettina Bernadotte, President of the Council

Lakeside Reception & Dinner



Present Your Research
NEXT GEN ECONOMICS

Wednesday, August 24, 11.00

Thursday, August 25, 11.00

Friday, August 26, 14.00



24 MEETING PROGRAMME THURSDAY AUGUST 25

Lecture

Corporate Social Responsibility

09.00

Oliver Hart

Inselhalle

Harvard University, United States of America

Lecture

Economic Dynamics, Inflation and Macroeconomic Inconsistencies

09.30

Joseph E. Stiglitz

Inselhalle

Columbia University, United States of America

Lecture

A Resolution of the Arrow Impossibility Theorem

10.00

Eric S. Maskin

Inselhalle

Harvard University, United States of America

10.30

Break

**Next Gen
Economics**

11.00

Inselhalle

with Laureates

Finn E. Kydland

Christopher A.

Pissarides

Christopher A. Sims

**Macroeconomics: Macro, Labor/Search, International,
Finance**

Robots and Wage Polarization:

The Effects of Robot Capital across Occupations

Daisuke Adachi

Aarhus University, Denmark

Monetary Policy and the Maturity Structure of Public Debt

Michele Andreolli

London Business School, United Kingdom

A Welfare Analysis of Occupational Licensing in U.S. States

Evan Soltas

Massachusetts Institute of Technology, United States of America

Private Activity Bonds as Investment Subsidy:

Evidence From the 1986 Bond Volume Cap Reduction

Lisa Knauer

Technical University Munich, Germany

**Immigrant Networks: Implications for Wages and Employment
Outcomes in a General Equilibrium Search Model**

Luke Rawling

Queen's University, Canada

**Moving Opportunity. Road Building and Education in Benin,
Cameroon, and Mali**

Luke Milsom

University of Oxford, United Kingdom

Quantifying the Extensive Margins of Trade and Production

David Torun

University of St. Gallen, Switzerland

The Natural Resource Boom and The Uneven Fall of The Labor Share

Andrés O. Dávila-Ospina

Univesidad de los Andes, Colombia, and University of Zurich, Switzerland

What is the Source of the Health Gradient? The Case of Obesity

Uta Bolt

UCL and IFS, United Kingdom

Bank Debt Versus Mutual Fund Equity in Liquidity Provision

Yiming Ma

Columbia University, United States of America

Moderator: Torsten Persson

Stockholm University, Sweden

**Next Gen
Economics**

11.00

Hotel Bayer. Hof

with Laureates

Robert C. Merton

Joseph E. Stiglitz

Richard H. Thaler

Applied Microeconomics: Environment, Health, Labor

Social Networks and Immigrant Integration:

Experimental Evidence from Sweden

Olle Hammar

Uppsala University, Sweden

Evolution vs. Creationism in the Classroom:

The Lasting Effects of Science Education

Benjamin Arold

Ludwig-Maximilians-Universität München, Germany

How Do Homebuyers Adapt After Experiencing a Natural Disaster?

Evidence From the Florida Real Estate Market

Timothy Hyde

University of Pennsylvania, United States of America

Are Pro-environment Behaviours Substitutes or Complements?

Evidence From the Field

Raisa Sherif

Max Planck Institute for Tax Law and Public Finance, Germany

Management Opposition, Strikes and Union Threat

Patrick Nüß

Kiel University, Germany

Signals of Charismatic Leadership in Virtual-Reality Communication

Theo Ravet-Brown

University of Liechtenstein, Liechtenstein

In Utero Exposure to Radiation Fear and Birth Outcomes:

Evidence from Fukushima Nuclear Power Plant Accident

Rong Fu

Waseda University, Japan

Locked-in at Home: Gender Difference in Analyst Forecasts

After the COVID-19 School Closures

Mengqiao Du

University of Mannheim, Germany, and National University of Singapore

Individualism, Innovation, and the Formation of Human Capital

Katharina Hartinger

Catholic University of Eichstaett-Ingolstadt, Germany

Mind-Reading Ability Predicts Sales Performance:

Evidence from Financial Consultants

Josie Chen

National Taiwan University, Taiwan

Moderator: Klaus M. Schmidt

Ludwig-Maximilians-Universität, Germany

13.00

Inselhalle 

Lunch Break

13.15

Various Locations



Laureate Lunches

Access: Laureates, young economists with online pre-registration only.

Please see your personal agenda for details.

Lecture

15.00

Inselhalle

The Importance of Seemingly Irrelevant Factors in Guiding Economic Policies

Richard H. Thaler

The University of Chicago, United States of America

Lecture Online

15.30

Inselhalle

Propriety, Property, and Price Discovery in Adam Smith and Classical Economics

Vernon L. Smith

Chapman University, United States of America

Lecture

16.00

Inselhalle

Choice: What Can Go Wrong?

Daniel L. McFadden

University of California, Berkeley, United States of America

16.30

Break

Panel Discussion

17.00

Inselhalle

Social Change and Social Media

Giovanni Andreottola

Vienna University of Economics and Business (WU), Austria

Katharina Hartinger

Catholic University of Eichstaett-Ingolstadt, Germany

Bengt R. Holmström

*MIT Massachusetts Institute of Technology, Department of Economics
United States of America*

Joseph E. Stiglitz

Columbia University, United States of America

Richard H. Thaler

The University of Chicago, United States of America

Moderator: Torsten Persson

Stockholm University, Sweden

Social Event

18.30 – 20.30

Inselhalle

Dinner

Access: young economists

Informal Exchange

LAUREATE LUNCHEAS AND SCIENCE WALKS

Please see your personal agenda for details.

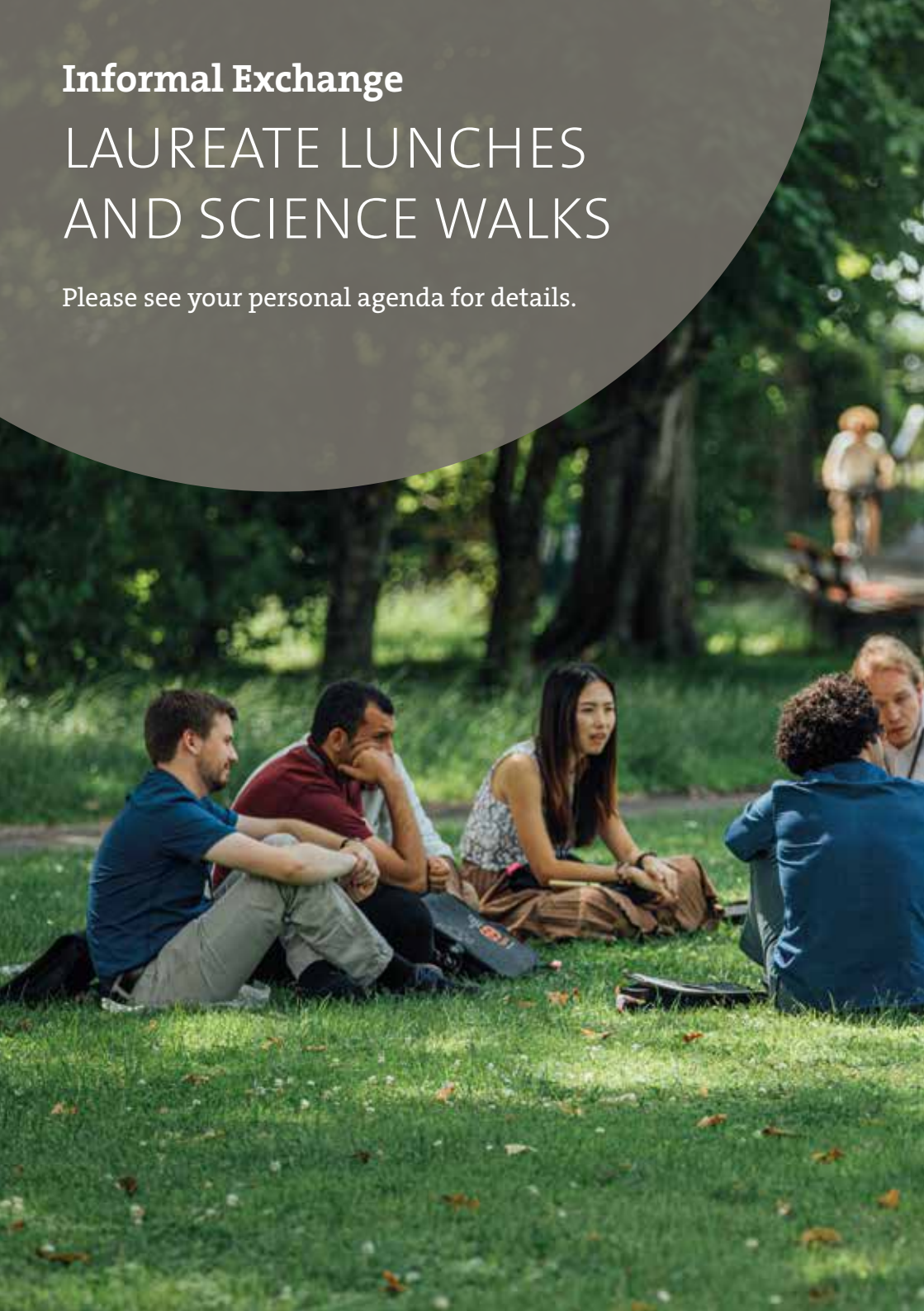



Morning Workout **Energize**

07.00

Oscar-Groll-Anlage

Partner Event

07.00

Hotel Bayer. Hof



Organizations as Quantum: A Surprising Consequence of Quantum Computer Proliferation

hosted by PricewaterhouseCoopers

Stefan Holtel

PricewaterhouseCoopers, Curator of Digital Change, Germany

Eric S. Maskin

Harvard University, United States of America

Moderator: Vera Daners

PricewaterhouseCoopers, Germany

08.30

Break

Lecture

09.00

Inselhalle

The New Theory of Innovation: Mass Flourishing and Dynamism

Edmund S. Phelps

Columbia University, United States of America

Lecture

09.30

Inselhalle

When Economic Growth in Spain, Italy, and Portugal Came to a Full Stop!

Finn E. Kydland

University of California, Santa Barbara, United States of America

Lecture

10.00

Inselhalle

The Future of Work and Well-Being; Post-Covid-19

Sir Christopher A. Pissarides

The University of London, United Kingdom

10.30

Break

Lecture

11.00

Inselhalle

Sharp Econometrics

Christopher A. Sims

Princeton University, United States of America

Lecture

11.30

Inselhalle

Applying Financial Science to Improve Global Retirement Funding & Finance SDGs with a Single Bond Innovation: SeLFieS

Robert C. Merton

MIT Massachusetts Institute of Technology, United States of America

12.00

Inselhalle

**Lunch Break**

12.15

Various Locations

**Laureate Lunches**

Access: Laureates, young economists with online pre-registration only.

Please see your personal agenda for details.

**Next Gen
Economics**

14.00

Inselhalle

with Laureates

Finn E. Kydland

Eric S. Maskin

Christopher A. Sims

Applied Microeconomics: Environment, Development, Labor

The Power of Youth:

Political Impacts of the “Fridays for Future“ Movement

Sebastian Wichert

ifo Institut - Leibniz-Institute for Economic Research & Ludwig-Maximilians-Universität München, Germany

The Carbon Contract Curve:

Which Climate Agreements are Mutually Beneficial?

Jonas Metzger

Stanford University, United States of America

A Revealed Preference Estimate of the Willingness-To-Pay to Avoid Power Outages: A California Case Study

Will Gorman

University of California, Berkeley, United States of America

Technology and State Capacity:

Experimental Evidence from Illegal Mining in Colombia

Santiago Saavedra Pineda

Universidad del Rosario, Colombia

The Health Externalities of Downsizing

Alexander Ahammer

Johannes Kepler University Linz, Austria

Carbon Literacy – Can Simple Interventions Help?

Sandra Kretschmer

Friedrich-Alexander University Erlangen-Nürnberg, Germany

‘Why’, ‘How Much’ or Both? Comparing Social Comparison and Real-Time Feedback to Promote Resource Conservation

Lukas Tomberg

RWI - Leibniz Institute for Economic Research, Germany

Transforming Brick Manufacturing in Bangladesh to Promote Clean Air and Better Health

Moogdho Mahzab

Stanford University, United States of America

Does Ignorance of Economic Returns and Costs Explain the Educational Aspiration Gap?

Katharina Werner

ifo Institute and University of Munich, Germany

Improving Financial Literacy by Mitigating Behavioural Biases: A Causal Mediation Analysis on the Effects of Behavioural-Based Financial Education

Francisco do Nascimento Pitthan

U Leuven, Belgium

Moderator: Antoinette Schoar

MIT Massachusetts Institute of Technology, United States of America

**Next Gen
Economics**

14.00

Hotel Bayer. Hof

with Laureates

Joshua D. Angrist

Paul R. Milgrom

Richard H. Thaler

Applied Microeconomics: Political Economics, Gender, IO**The Geography of Black Economic Progress After Slavery***Lukas Althoff**Princeton University, United States of America***Can Wage Transparency Alleviate Gender Sorting in the Labor Market?***Lennart Ziegler**University of Vienna, Austria***The Unswayed Voter:****How a Polarized Electorate Responds to Economic Growth***Robert Embree**University of Toronto, Canada***Gender Norms and Specialization in Household Production:
Evidence from a Danish Parental Leave Reform***Anne Sophie Lassen**Copenhagen Business School, Denmark***Who Is to Suffer? Quantifying the Impact of Sanctions on German Firms***Saskia Meuchelböck**Kiel Institute for the World Economy, Germany***Building the “Rainbow Nation” Through Mass Media: Television, Cultural
Diversity, and National Unity in Post-apartheid South Africa***Tomohiro Hara**University of Maryland at College Park, United States of America***Earnings Disclosure by Politicians***Carina Neisser**University of Cologne, Germany***The Racial Gap in the Patenting Process***Gaia Dossi**London School of Economics, United Kingdom***Modern Slavery - An Empirical Analysis***Bianca Willert**Friedrich-Alexander-Universität Erlangen-Nürnberg, Germany***Moderator: Torsten Persson***Stockholm University, Sweden*

16.00

Break

34 MEETING PROGRAMME FRIDAY AUGUST 26

Science Walks

16.15

Science Walks

Meeting Point: main entrance of the Inselhalle.

Access: Laureates, young economists with online pre-registration only.

Please see your personal agenda for details

Social Event

19.00 – 22.00

Inselhalle



Bavarian Evening

hosted by the Free State of Bavaria

Welcome

Countess Bettina Bernadotte, President of the Council

Folk Dance

Trachtenverein Altusried

Bavarian Dinner

Online Event

19.30 – 22.00

Interactive Bavarian Evening with Brian Malow

See live.lindau-nobel.org for details.

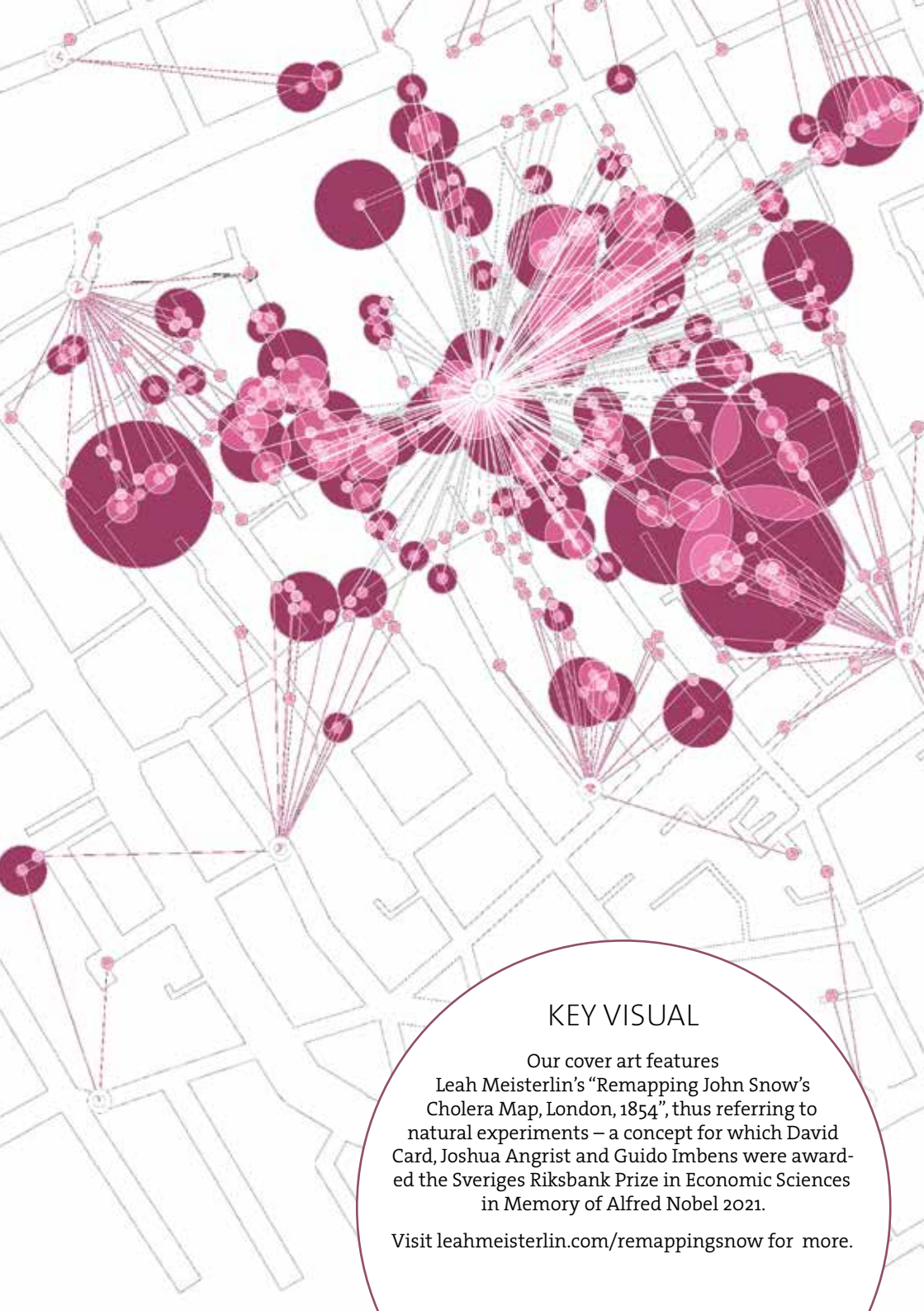

KEY VISUAL

Our cover art features Leah Meisterlin's "Remapping John Snow's Cholera Map, London, 1854", thus referring to natural experiments – a concept for which David Card, Joshua Angrist and Guido Imbens were awarded the Sveriges Riksbank Prize in Economic Sciences in Memory of Alfred Nobel 2021.

Visit leahmeisterlin.com/remappingsnow for more.





Blast from the Past

BAVARIAN BREAKFAST 1953

70 years ago, the Bavarian Evening was actually a Bavarian Breakfast. Until today, a decent amount of beer and “weisswurst” are common during such a breakfast, as demonstrated in this picture by Nobel Laureate Hideki Yukawa and his wife Sumi.

Social Event

08.15
MS Sonnenkönigin

Boat Trip to Mainau Island

Note for all participants departing on Saturday and not returning to their hotel: no luggage may be taken on the boat. Two luggage lorries will be available at Lindau Harbour; please place your luggage accordingly.

Lorry 1 to “Mainau Island”: for those not returning to Lindau. Pick-up is at main entrance on Mainau Island until 17.00 hrs.

Lorry 2 to “Lindau”: for those leaving directly after their return to Lindau. Pick-up is at Lindau Harbour immediately after arrival.

07.30 – 08.00
Lindau Harbour

Check-in (Lindau) for young economists

08.15
Lindau Harbour

Departure (Lindau)

08.30



Welcome

Countess Bettina Bernadotte, President of the Council

10.20
Mainau Island

Arrival (Mainau Island)

11.00
Mainau Island
Castle Meadow

Welcome on Mainau Island

Countess Bettina Bernadotte, President of the Council

Closing**Panel Discussion**

11.10

Mainau Island
Castle Meadow**Economics and Politics of War and Sanctions**

Oliver Hart

Harvard University, United States of America

Eric S. Maskin

Harvard University, United States of America

Saskia Meuchelböck

Kiel Institute for the World Economy, Germany

Sir Christopher A. Pissarides

The University of London, United Kingdom

Moderator: Klaus Schweinsberg

Centre for Strategy and Higher Leadership, Germany

12.30

Mainau Island
Castle Meadow**Conclusion & Farewell**

Countess Bettina Bernadotte

President of the Council

13.00

Mainau Island
Arboretum**Science Picnic on the Arboretum Lawn**

16.00

Mainau Harbour

Boarding

16.30

Mainau Harbour

Departure (Mainau)

18.45

Lindau Harbour

Arrival (Lindau)



Now or Never CONNECT

The boat rides on the closing day are the perfect opportunity to connect to your peers. They are all there.

Also, join the Lindau Alumni Network to stay in touch and keep the Lindau Spirit.



42 ABOUT THE MEETINGS

The Meetings

The Lindau Nobel Laureate Meetings – established in 1951: more than 70 years ago – provide a globally recognised forum for exchange between Nobel Laureates and young scientists. They inspire scientific generations and build sustainable networks of young scientists around the world.

The original idea of the meetings goes back to the two Lindau physicians Dr. Franz Karl Hein and Professor Dr. Gustav Wilhelm Parade as well as Count Lennart Bernadotte af Wisborg, a member of the Swedish royal family who quickly became the spiritus rector of the Lindau Meetings. It was them who recognised very early the significance of the meetings for the reconciliation of the people of post-war Europe and thus systematically developed them to an international forum for the exchange of knowledge between nations, cultures and disciplines.

The Organisers

The Council for the Lindau Nobel Laureate Meetings and the Foundation Lindau Nobel Laureate Meetings organise the annual one-week events; economics meetings are held every third year. The executive secretariat is responsible for planning and realisation. Countess Bettina Bernadotte af Wisborg is president of the Council, which sets the course for the Lindau Meetings' concept and programme. Internationally accredited scientists from the fields of medicine, physics, chemistry and the economic sciences are members of the Council. The work of the Council benefits from the commitment of the secretaries of the assemblies responsible for awarding the Nobel Prizes, which are represented in the Council.

The Foundation was established in the year 2000 by the Council and the Bernadotte family on the initiative of 50 Laureates. Following Prof. Dr. h.c. Wolfgang Schürer, since 2016 Prof. Dr. Jürgen Kluge serves as the chairman of the board of the Foundation. Joint initiatives regarding the advancement of the Lindau Meetings and the establishment of an international network of academic partners are key priorities in addition to ensuring sustainable funding.

The Lindau Meetings enjoy widespread support. More than 350 Nobel Laureates are members of the Founders' Assembly of the Foundation and demonstrate – through their membership and their engagement with the Lindau Spirit – their support for the mission of the Lindau Nobel Laureate Meetings.

Personalities from the worlds of science, politics and industry have been inaugurated into the Foundation's Honorary Senate in recognition of the special commitment they have shown towards scientific excellence and the promotion of young scientists.

Funding of the Lindau Nobel Laureate Meetings

The Lindau Nobel Laureate Meetings are made possible thanks to the support received from supranational, national and state bodies, companies, associations and private patrons. International companies, selected foundations, associations and private maecenates assure the financial basis for the Lindau Meetings by making donations to the assets of the Foundation Lindau Nobel Laureate Meetings. Interest earned on the endowment, plus additional annual contributions by benefactors cover the budget of the Lindau Meetings. Donations in kind also play an important role in raising the professional level of the meetings. Not least, the success of the Lindau Meetings can also be attributed to the commitment shown by the Laureates, members of the Council and the board of the Foundation during the preparation, realisation and evaluation of the meetings. A full list of supporters is enclosed in this programme.

The Academic Partners Network

The Lindau Nobel Laureate Meetings interact closely with a global network of academic partners to identify highly-talented young scientists/economists and to nominate them for participation. Partners include national academies of science, ministries, research institutions, top-ranking universities, foundations and international scientific organisations. Without this support, the Lindau Nobel Laureate Meetings would not be able to identify and invite the most gifted scientific talents worldwide.

The world's best young scientists of tomorrow submit applications to attend the Lindau Nobel Laureate Meetings. An international, multi-stage selection process guarantees that the scientific elite of the future is able to gather with the Laureates in Lindau. Every year, several thousand young scientists apply worldwide.

44 ABOUT THE MEETINGS

Programme Session Types

The formats of the varied scientific programme are based on the principle of dialogue and to activate the exchange of knowledge, ideas, and experience between and among Laureates and young economists.

Lectures

Lectures are given by Laureates only. They may choose a topic of their liking – be it their Nobel Prize research, be it something else.

Panel Discussions

Several panellists jointly discuss one topic. Up to half of the time is dedicated to Q&A with the audience.

Next Gen Economics Sessions

Oral presentations by young economists. Each presentation is 6-10 minutes, followed by a short Q&A.

Workouts

Need a break? Join our workouts.

Partner Events & Partner Breakfasts

Partners of the Lindau Meetings are invited to organise side events outside the core programme, e.g., in the mornings as Partner Breakfasts. As for the content of the presentations, several types are possible, e.g. panel discussion, world café, normal dinner, pitch presentations, etc. Attendance requires online pre-registration.

Science Walks

During a Science Walk, Laureates spend their time exploring picturesque spots in Lindau and its surroundings together with up to ten young economists. It is yet another opportunity for personal and informal discussions.

Laureate Lunches

During a Laureate Lunch, a Laureate sits together with up to ten young economists at a local restaurant in Lindau to talk informally over lunch.

THE LINDAU GUIDELINES

01 Adopt an Ethical Code

02 Cooperate Globally on Global Problems

03 Share Knowledge

04 Publish Results Open Access

05 Publish Data to Repositories

06 Work Transparently & Truthfully

07 Change Reward Systems

08 Support All Talent

09 Communicate to Society

10 Engage in Education

SIGN
SUPPORT
SPREAD

lindauguidelines.org

GOT QUESTIONS?

Visit qa.lindau-nobel.org to ask your questions during panel discussions.

TWITTER

#LINO
@lindau

ALUMNI NETWORK

Meet your peers at
alumni.lindau-nobel.org

MENTORING HUB

Interested in becoming
a mentor or a mentee?
mentoringhub.lindau-nobel.org

RE

Most of the
afterwa

mediatl
m

ERATI

**econ
nobel**

ABSTRACTS

Session abstracts are available at

[mediatheque.lindau-nobel.org/abstracts/
meeting-2022-econ](https://mediatheque.lindau-nobel.org/abstracts/meeting-2022-econ)

&

[mediatheque.lindau-nobel.org/program/
meeting-2022-econ](https://mediatheque.lindau-nobel.org/program/meeting-2022-econ)

WATCH

Some sessions will be available
on video in our mediatheque:

[mediatheque.lindau-nobel.org/
meetings/2022-econ](https://mediatheque.lindau-nobel.org/meetings/2022-econ)

IN-DEPTH COVERAGE

Check our blog for additional
in-depth coverage:
blog.lindau-nobel.org

48 ENDOWMENT CONTRIBUTORS

The Lindau Nobel Laureate Meetings would like to thank all maecenates, patrons and donors for their contributions to the endowment of the Foundation.

PRINCIPAL MAECENATES

Klaus Tschira Stiftung gGmbH

Mars, Incorporated

MAECENATES

AstraZeneca

Bayer AG

Ecoscientia Stiftung

Freistaat Bayern - Bayerisches Staatsministerium für Wissenschaft und Kunst

Robert Bosch GmbH

Rolex SA

SAP SE

Thomas Schmidheiny

Verband der Bayerischen Metall- und Elektroindustrie

PRINCIPAL PATRONS

Bertarelli Foundation

Carl Zeiss Stiftung

Monika and Wolfgang Schürer

National Research Foundation, Singapore

Novartis International AG

Siemens AG

Südwestmetall Verband der Metall- und
Elektroindustrie Baden-Württemberg e. V.

Swiss Re Ltd

Verein der Bayerischen Chemischen Indus-
trie e.V.

PATRONS

China-Singapore Guangzhou Knowledge City Investment and Development Co., Ltd
LafargeHolcim Ltd.

PRINCIPAL DONORS

Boehringer Ingelheim GmbH
Carl Zeiss AG
Croucher Foundation
Hansjörg Wyss Medical Foundation
Jacobs Foundation
Jörnwall Foundation
Klaus and Renate Gehrig
maxingvest ag (Tchibo Holding AG)
Merck KGaA
Synthes-Stratec Inc.
The Vallee Foundation Inc.
Verband der Chemischen Industrie e.V. (VCI)

DONORS

Alexander and Katalin Dembitz	Christian de Duve
André Pienaar	Christopher Schläffer
Andreas J. Büchting	Daniel and Greta Wilm
AnneMarie Lynen	Edmond H. Fischer
Artur Fischer	ETO GRUPPE
Astrid und Carl-Thomas Epping	Eva Lynen
Bert Sakmann	Familie Franz Karl Hein
Brian P. Schmidt	Familie Graf Lennart Bernadotte af Wisborg
C5 Capital	Florian Budde
Charles Townes	Fondazione Fidinam

50 ENDOWMENT CONTRIBUTORS

Fredy and Regula Lienhard	Martin Hellwig
Fresenius SE & Co. KGaA	ODDO BHF AG
Gabriele David	Paul Crutzen
Gary L. and Fang Bridge	Paula Jean Hirsch
George Pinto	Peter D. Dornier
Heinz and Heide Dürr Stiftung	PwC PricewaterhouseCoopers AG
Hendrik Leber and Claudia Giani-Leber	Richard C. Barker
Herbert Lütkestratkötter	Robert Stolze
Innovative Business Foundation Ltd.	Ruth Schilling
Jack Steinberger	Salus Charity Foundation
Jerome Karle	Simon W. and Alice I. Newman
Joachim and Bärbel Milberg	Sparkasse Memmingen-Lindau-Mindelheim
Joachim Dübner	Stiftung GAMBIT
Joachim Friedrich Scheele	Stiftung Hilfe zur Selbsthilfe
Johann Deisenhofer and Kirsten Fischer	Toyota Mobility Foundation
Lindahl	Ulrich B. Stoll
John Robin Warren	Volkmar and Gabriele Denner
Jörn Wilkening	Werner Arber
Lemann Foundation	Wesley Harry
Leopoldina Nationale Akademie der Wissenschaften	William E. and Sharon Moerner
Lindau Alumni Fund	Zülow AG
Lyndon L. Olson and Mrs. Olson	Zumtobel Lighting GmbH
Maja Dornier	

Anonymous endowment contributors as well as the Friends of the Foundation



MANET
RENOIR
MONET
GAUGIN
LIEBERMANN
MACKE
AND MORE

Claude Monet, La maison à travers les roses c. 1915-26, oil on canvas,
Courtesy Galerie von Vertes, Zürich

Mythical Nature

FROM
MONET TO
WARHOL

ART MUSEUM LINDAU

30 APRIL - 03 OCTOBER 2022

OPENING HOURS: 10.00 - 18.00 HRS

52 MEETING SUPPORTERS

The Lindau Nobel Laureate Meetings would like to thank all supporters of the 7th Lindau Meeting on Economic Sciences

SIGNIFICANT MEETING BENEFACTORS

Dieter Schwarz Stiftung gGmbH

Klaus Tschira Stiftung gGmbH

Mars, Incorporated

Prof. Otto Beisheim Stiftung

Robert Bosch GmbH

Rolex SA

PRINCIPAL BENEFACTORS

Bayerisches Staatsministerium für Wissenschaft und Kunst

Carl-Zeiss-Stiftung

Deutsche Forschungsgemeinschaft (DFG)

Deutsche Post-Stiftung

Foundation Lindau Laureate Meetings and their endowment contributors & Förderstiftung für die Lindau Laureate Meetings

International Lake Constance Conference (IBK)

Max-Planck-Gesellschaft zur Förderung der Wissenschaften e.V. (MPG)

National Research Foundation, Singapore

BENEFACTORS

AKB Stiftung – Stiftung der Familie Carl-Ernst-Büchting
 Christa und Hermann Laur-Stiftung
 Deutscher Akademischer Austauschdienst (DAAD)
 Deutscher Sparkassen- und Giroverband
 Fraunhofer-Gesellschaft zur Förderung der angewandten Forschung e.V.
 Lennart-Bernadotte-Stiftung
 Lindau Tourismus und Kongress GmbH
 Mainau GmbH
 Peter-Dornier-Stiftung
 Piekalnitis-Weber Family, Stuttgart
 PwC PricewaterhouseCoopers AG
 Roche Deutschland Holding GmbH
 Schweizerische Nationalbank
 Sparkassenverband Bayern
 Sparkasse Schwaben-Bodensee
 Spielbank Lindau
 Staatliche Lotterie- und Spielbankverwaltung
 Stadt Lindau (B)
 Stiftung van Meeteren
 The Nobel Foundation
 Wissenschaftsgemeinschaft Gottfried Wilhelm Leibniz e.V.

CONTRIBUTORS

Bayerische Staatsbrauerei Weihenstephan
 Mineralbrunnen Krumbach GmbH
 SWS-Medicare GmbH
 Tchibo GmbH

and anonymous benefactors

Ground Floor

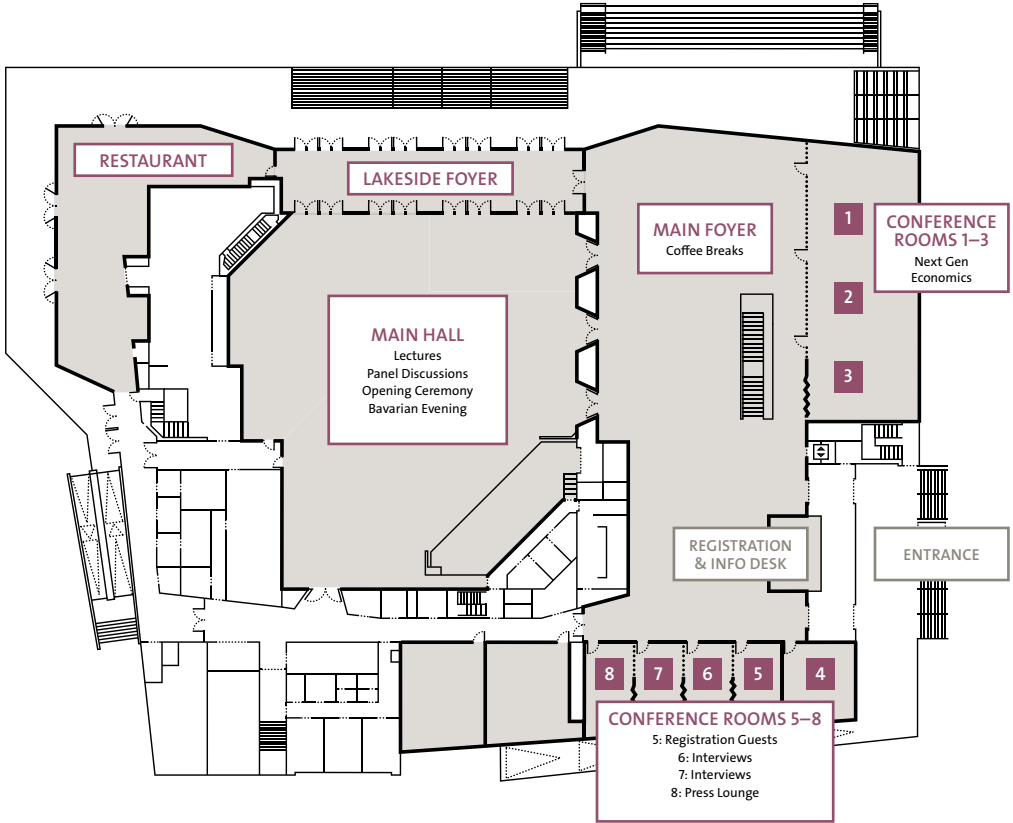

What	Where
Bathrooms	Basement
Coffee Breaks	Main Foyer
Dinner	Various locations. In the Inselhalle: Lounge in the basement
Lectures	Main Hall
Lunch	Basement Laureate Lunches: various destinations
Next Gen Economics	Inselhalle Conference Rooms 1–3 & Hotel Bayerischer Hof
Panel Discussions	Main Hall

Lower Floor/Basement

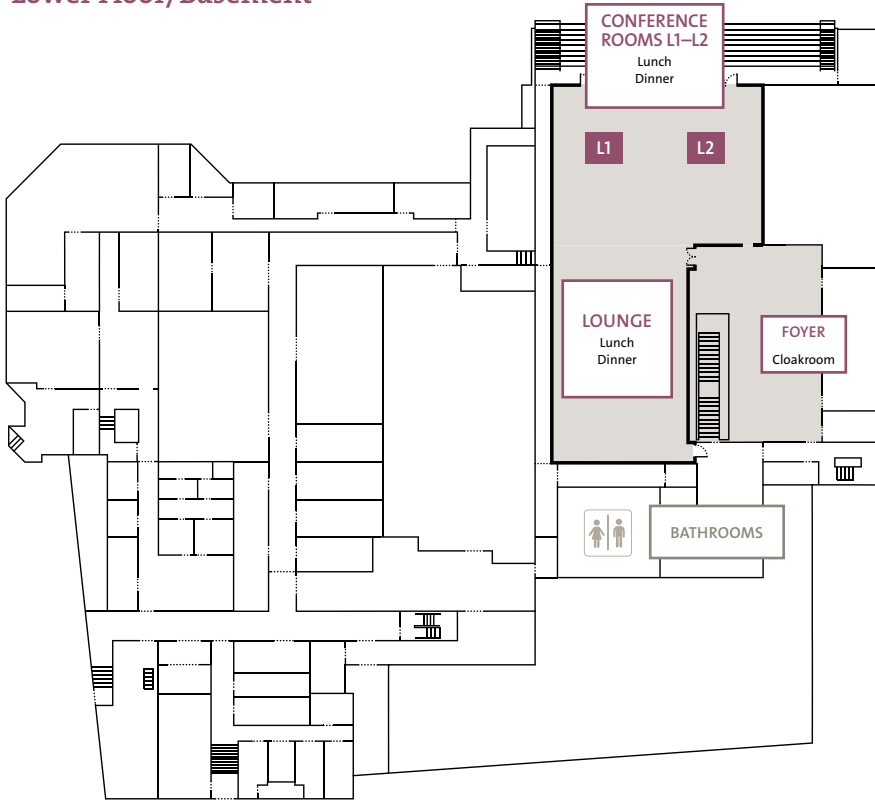

What

Where

Partner Breakfasts Hotel Bayerischer Hof

Press Lounge Conference Room 8

Science Walks Meeting Point: Main Entrance of the Inselhalle

Social Events Various locations. In the Inselhalle: Main Hall and Basement

PROGRAMME LOCATIONS



Kunstmuseum
am Inselbahnhof

Hotel
Bayerischer Hof

Lindau Harbour

Lindau - Bad Schachen/Meersburg/Konstanz

Inselhalle

Workout
(bad weather)

Workout
(nice weather)



Parking

P4



Bus Stop

Lindau - Bregenz

PROGRAMME RESTAURANTS

Hotel Engel
Schafgasse 4



Valentin
In der Grub 28

Cantinetta
Chelles-Allee 1







0 100 500 1000 m

62 GOOD TO KNOW

Bus: How to Read the Timetable

The timetable available at the front desk shows operating hours and departure times for all five lines and both directions. The first three columns (earliest, Saturday, Sunday) indicate when the earliest bus runs from each stop, while the fourth column shows the last service. The next column (every 30 min) shows when buses depart between the first and last service. Example: 24/54 means that this bus departs from the station every hour at minute 24 and 54 (e.g., at 15.24 hrs and 15.54 hrs). The two rightmost columns provide times for the night service (Friday/Saturday only).

Dietary Needs

Should you have any dietary needs, please make sure to check with our service desk or the catering service.

Medical Assistance

- In case of urgent, life-threatening medical issues, call 112 and/or contact any member of our staff.
- In case of urgent, but not life-threatening medical issues, please contact the paramedic teams on site or see our service desk.
- In case of non-urgent medical issues, please see our service desk.

Code of Conduct

The meetings have implemented a code of conduct, detailing appropriate and inappropriate behaviour. Please make sure to adhere to it. See code.lindau-nobel.org for details.

If you feel that the meetings' code of conduct has been violated in a substantial way, you may contact any of the chairpersons, front desk staff, or write to coc-violation@lindau-nobel.org.



RESPONSIBILITY

The Lindau Laureate Meetings and its boards, team and staff are working hard to leave a positive footprint.

Since 2020, we are a climate-positive event.

Encouraged by the young scientists' initiative IDEA, we are also continuously improving aspects of inclusion and diversity.

Read more about the details at www.lindau-nobel.org/responsibility

Opening Hours Desks

Date	Young Economists	Guests	Press
Monday, 22 August	13.00 – 18.00	–	–
Tuesday, 23 August	08.30 – 19.00	08.30 – 19.00	10.00 – 18.30
Wednesday, 24 August	08.30 – 17.00	08.30 – 17.00	08.30 – 18.00
Thursday, 25 August	08.30 – 17.00	08.30 – 17.00	08.30 – 18.00
Friday, 26 August	08.30 – 16.30	08.30 – 16.30	08.30 – 18.00

On-site Contacts

The office can be reached during the meeting as follows:

Registration Desk	Tel +49 8382 8899 621
Press Desk	Tel +49 8382 8899 638
Email (general)	info@lindau-nobel.org
Email (Covid-19)	covid-19@lindau-nobel.org
Email (Code of Conduct)	coc-violation@lindau-nobel.org
Emergency	112
Taxi	Tel. +49 8382 5050 and +49 8382 3550

Lanyard Colour Key

Turquoise	Laureates, their partners and family members
Grey	Young Economists
Blue	Visiting Economists
Red	Guests
Yellow	Journalists
Orange	Contractors
Brown	Shuttle Service & External Service Providers
Green	Council & Foundation
Black	Staff of the Executive Secretariat

Scientific Chairpersons of the 7th Lindau Meeting on Economic Sciences

Torsten Persson

Professor of Economics
Stockholm University, Sweden

Klaus M. Schmidt

Professor of Economics
Ludwig-Maximilians-Universität, Germany

Antoinette Schoar

Stewart C. Myers-Horn Family Professor of Finance and Entrepreneurship
MIT Massachusetts Institute of Technology, United States of America

Future Meetings

72nd Lindau Nobel Laureate Meeting (Physiology/ Medicine)

25 June – 30 June 2023

73rd Lindau Nobel Laureate Meeting (Physics)

30 June – 5 July 2024

74th Lindau Nobel Laureate Meeting (Chemistry)

29 June – 4 July 2025

8th Lindau Meeting on Economic Sciences

26 August – 30 August 2025

75th Lindau Nobel Laureate Meeting (Interdisciplinary)

28 June – 3 July 2026



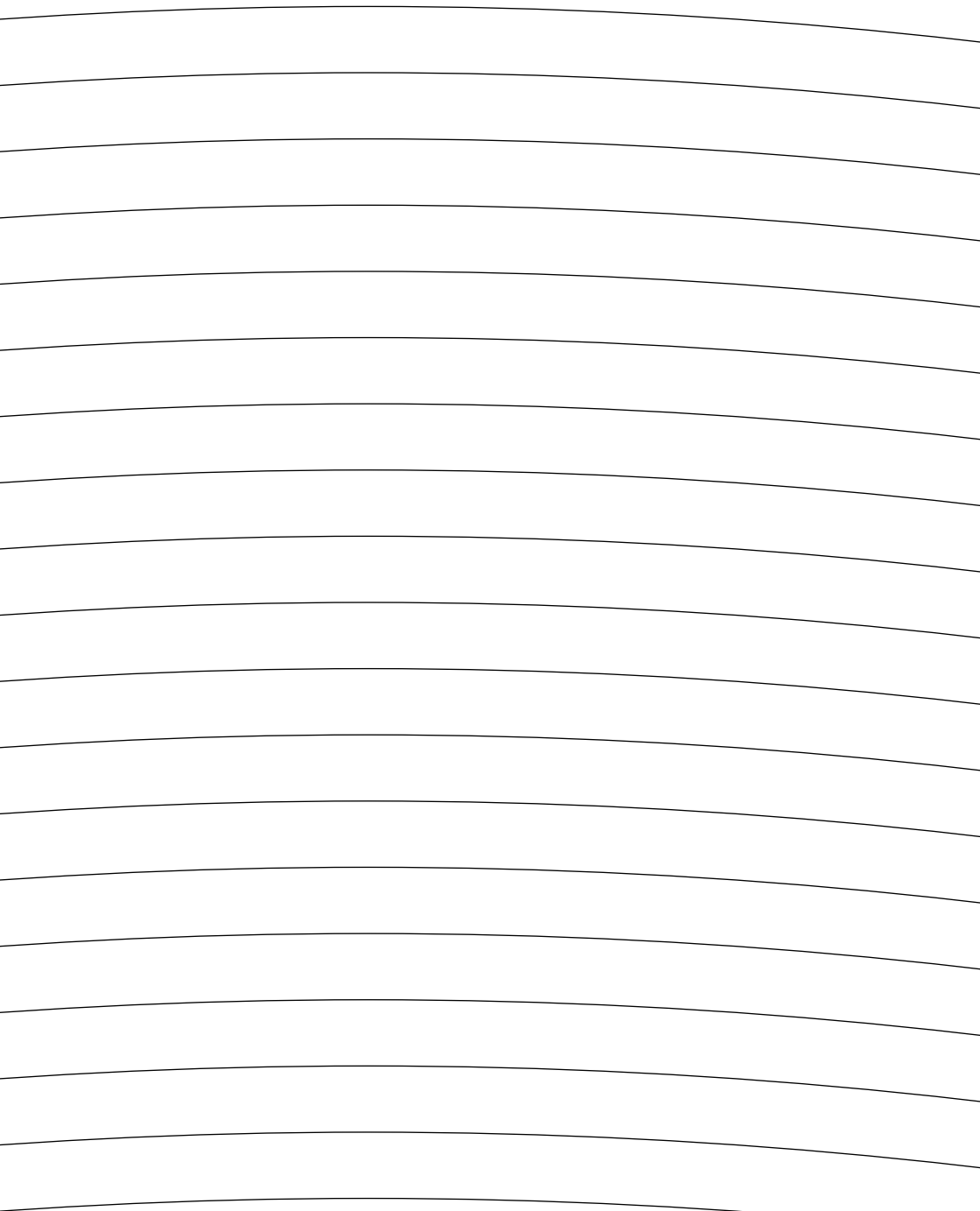



Council for the
Lindau Nobel Laureate Meetings

Foundation
Lindau Nobel Laureate Meetings

Alfred-Nobel-Platz 1
88131 Lindau
Germany

www.lindau-nobel.org